



Product Info

ICU/RED/PRF/STD/0219

Product

REDiBOX®

Permanent Recess Former

Version

REDiBOX® PRF-STD

Used in combination with

RVK 101, TSS 41, TSS 101 & TSS 102 Stair Connectors

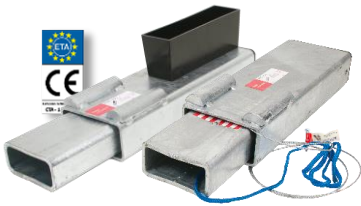

Associated accessories from iC

Levelling shims and foam rod

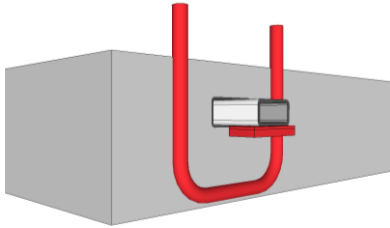

About Invisible Connections

Invisible Connections is the registered trademark of Invisible Connections AS, the Norwegian developer of telescopic connection systems used worldwide. The ETA approved connectors solve two key construction applications; 'invisible' connections for precast staircase construction and 'invisible' connections for precast beam construction.

To enhance its offering to the UK market, Invisible Connections Ltd also supplies the CARES approved FERBOX reinforcement continuity system, which is bespoke-manufactured for in situ concrete connections.

Our products appeal to precast concrete manufacturers and in situ concrete frame contractors who appreciate the fuss free ease with which precast or in situ elements can be connected.

Invisible Connections Ltd

Unit 6, Thame Forty
Jane Morbey Road
Thame, Oxfordshire OX9 3RR
+44 (0)1844 266000
sales@invisibleconnections.co.uk
invisibleconnections.co.uk



REDiBOX® PRF-STD (Standard Version)

A purpose-designed 'left-in' component for easy forming of recesses in concrete walls (precast or in situ). Suitably sized to complement the sliding inner sections of standard TSS & RVK Telescopic Connectors (all load ranges) prior to receiving cementitious

grout-fill. Its design provides +/- 35mm (min) vertical tolerance and +/- 40mm (min) horizontally. The REDiBOX Permanent Recess Former is manufactured from durable and environmentally recyclable HDPE.

Product features

The embedded box element is heavily ribbed on all sides, comprehensively anchoring it into the concrete wall. The rear of the detachable face-plate has an inset perimeter rib, which provides a close fit to the box and which also maintains the shape of the recess former under concrete pressure. The unit is fully sealed, which ensures that the recess will be clean once the face-plate is removed. The face-plate can be nailed to timber moulds or shutters.



Alternatively, the integral lugs (two on four sides) provide ample fixing points to tie-wire the unit to the wall reinforcement (ideal for slip-forms). The recyclable face-plate incorporates a central 'soft-eye' into which a hammer-claw can be inserted to pull and detach, revealing the clear recess.

Dimensions and setting-out guidance

The resultant recess measures (internally) 180mm wide x 120mm high x 104mm deep. Setting-out in the wall should be from the top edge of the face-plate which, if an RVK 101 connector is specified, should be 27mm below the top of the landing. If a TSS connector is specified, the setting-out is project-specific, due to the variable depth of the TSS connector within the slab.

Setting-out to suit RVK telescopic connectors

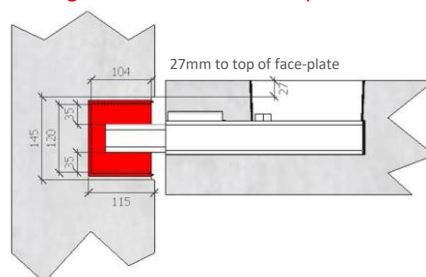

Setting-out to suit TSS telescopic connectors

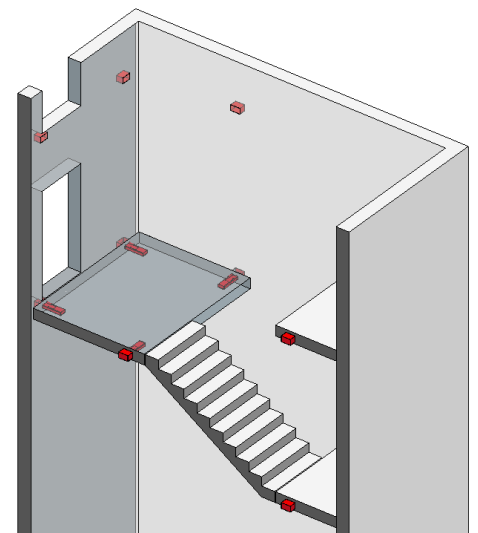
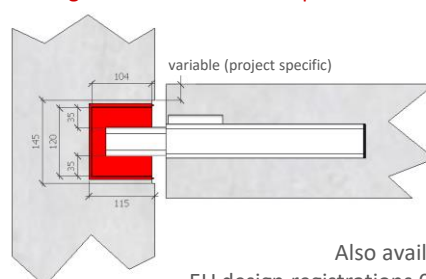

Also available: **REDiBOX PRF-PIN** (to suit tied-wall applications)
EU design registrations 004073187-0001/0002 & 004670107-0001/0002/0003