

# CHARCON

## HARD LANDSCAPING

ECO COUNTRYSIDE CYCLE KERB

TECHNICAL INFORMATION  
www.aggregate.com/cyclekerb

## ECO COUNTRYSIDE™ CYCLE KERB

### KERBS



A NEW INNOVATIVE INTEGRATED SYSTEM DESIGNED TO SAFELY SEGREGATE CYCLISTS FROM PASSING TRAFFIC.

Eco Countryside Cycle Kerb is a one piece unit.

Capable of withstanding vehicular impact.

Replicating the aesthetics of natural granite Eco Countryside Kerb offers a 33% carbon reduction in comparison to a natural granite alternative.

Raw materials selected for their environmental benefits with 82% recycled and reclaimed material content.

Offer strong visual synergy with the Charcon flag and block paving ranges.

Available in black fleck shade for added visual appeal.

Also available in Standard Grey.



BES 6001  
Responsible Sourcing  
www.bes6001.org.uk



82%<sup>†</sup> non-primary materials

### APPLICATIONS

Specifically designed to safely segregate cyclists from passing traffic. Eco Countryside Cycle Kerb is ideal for use in areas where product appearance and environmental considerations are important criteria.

### MANUFACTURING STANDARD

Eco Countryside Cycle Kerb is manufactured using a wet pressed process and is manufactured in accordance with and complies with all relevant sections of BS EN 1340: Concrete Kerb Units – requirements and test methods. The kerb is then shot blasted to expose the aggregate.

Aggregate Industries fully operates an accredited Quality Assurance scheme, certified to BS EN 9001:2008 which is independently and regularly assessed by BSI (British Standards Institution). All Aggregate Industries manufacturing sites are also certified to BS EN 14001 Environmental Management Systems.

### PERFORMANCE WITH SLIP RESISTANCE

Unpolished slip resistance values, when tested in accordance with BS EN 1340, are available on request. All Aggregate Industries kerb units are classified as having a low potential for slip.

Polished slip resistance values can be provided on request.

### COMPLEMENTARY PRODUCTS

Designed for use with Aggregate Industries flag and block paving ranges, particularly EcoPave and Appalachian flag paving.



### COLOUR SWATCH

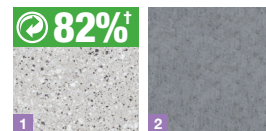

1. Black Fleck
2. Grey



OHS 61759



FM 96927



EMS 96928



Q10.  
For NBS clauses, refer to Aggregate Industries technical services.

# ECO COUNTRYSIDE™ CYCLE KERB

## KERBS

PRODUCT DATA								
Sizes (mm)	Unit type	Weight (kg)	Units/m	No. per pack	M/pack (approx)	Pack weight (T)	Colour available	Profile
914x500x175	Cycle Segregation Unit	168	1.09	3	2.8	0.51	BF, Gy	Splay/Square
914x145x175	Standard Kerb	48	1.09	14	12.8	0.76	BF, Gy	Splay
914x145x175	Standard Kerb	54	1.09	14	12.8	0.68	BF, Gy	Square
914x145x255	Standard Kerb	72	1.09	14	12.8	1.01	BF, Gy	Splay
914x145x175	LH Transition SP/SQ	51	1.09	7	6.4	0.36	BF, Gy	Splay/Square
914x145x175	RH Transition SP/SQ	51	1.09	7	6.4	0.36	BF, Gy	Splay/Square
914x500x175	Transition Quadrant LH	173	1.09	3	2.8	0.52	BF, Gy	Square
914x500x175	Transition Quadrant RH	173	1.09	3	2.8	0.52	BF, Gy	Square
250x250x255	Quadrant	29	n/a	4	-	0.12	BF, Gy	Square
450x450x175	Quadrant	64	n/a	2	-	0.13	BF, Gy	Square
500x500x175	Quadrant	79	n/a	2	-	0.16	BF, Gy	Square

A full range of accessories are available. Please refer to page 100 for further details.  
BF - Black Fleck / Gy - Grey.  
All MTO.

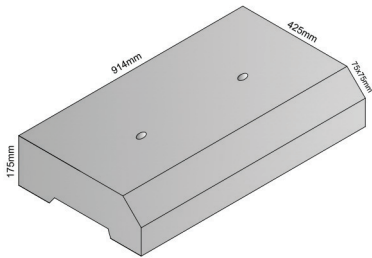

Cycle Segregation kerb

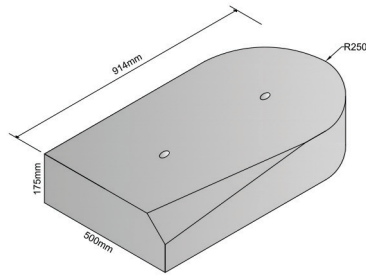

Transition Quadrant (LH shown)



# ECO COUNTRYSIDE™ CYCLE KERB

## KERBS

### SUSTAINABILITY AND LOCAL SOURCING

**ENERGY USE:** Aggregate Industries is at the forefront of sustainability and has committed to reduce carbon emissions by 20% by 2016 based on a 2012 base line.

**RECYCLABLE:** 100% of the product can be recycled thus reducing the amount of material that is sent to landfill.

**MANUFACTURING LOCATION:**

Produced in the UK, with locally sourced materials under strict environmental and social legislation, for local supply.

**RESPONSIBLE SOURCING:** Aggregate Industries is the first company in the world to achieve accreditation to the BES 6001 Framework Standard for the Responsible Sourcing of Construction Products.

Aggregate Industries has achieved a 'Very Good' rating for major product groups. The BES 6001 standard assesses:

- .....
- Quality management.
- .....
- Environmental management.
- .....
- Health and safety management.
- .....
- Greenhouse gas emissions.
- .....
- Minimising raw material usage.
- .....
- Labour practice.
- .....
- Biodiversity.
- .....
- Community engagement.
- .....

### LIFE

Life is our range of sustainable products and services. For more information please visit [www.aggregate.com/life](http://www.aggregate.com/life)

### KEY AGGREGATE AND RECYCLED CONTENT

Eco Countryside Kerb is manufactured using high quality, hard wearing granite aggregates with 82% recycled material content.

### GENERIC GREEN GUIDE RATING\*

Not applicable.

### POLICIES

Aggregate Industries' policies on the environment and community, health and safety and sustainable solutions for different product applications can be viewed on our website [www.aggregate.com](http://www.aggregate.com)

### DESIGN AND INSTALLATION

For successful installation refer to BS 7533 Part 6. For specific design, installation and maintenance guidance, please contact our technical department on 01335 372222.

### MAINTENANCE AND CLEANING

Aggregate Industries can supply on request advice on specific stain removal and general maintenance, suitable cleaning products and referrals to specialist cleaning companies.

### COSHH DATA

Full COSHH data on the Charcon range of products is available on request. Please call the technical helpline on 01335 372222.

### TECHNICAL SUPPORT

DETAILED GUIDANCE AND ASSISTANCE WITH THE PREPARATION OF SPECIFICATION OF THE CHARCON RANGE OF HARD LANDSCAPING PRODUCTS, INCLUDING MODEL CLAUSES, IS AVAILABLE THROUGH THE SALES OFFICE. A FREE TECHNICAL DESIGN SERVICE IS ALSO AVAILABLE.

**FOR FURTHER INFORMATION, PLEASE REFER TO OUR TECHNICAL SERVICES ON 01335 372222.**

\*Ratings based upon generic green guide values (2009) supplied by BRE Global Ltd, [www.thegreenguide.co.uk](http://www.thegreenguide.co.uk)

The information contained within this publication was accurate at time of production. However, Aggregate Industries reserves the right to introduce modifications or changes to detail at any time without notice. No charge is levied for this publication or advice therein, and accordingly the company, its employees and authorised agents can accept no liability whatsoever, either indirectly or directly arising from the use of its products.

### Charcon

Aggregate Industries, Hulland Ward,  
Ashbourne, Derbyshire DE6 3ET

Tel: +44 (0)1335 372 222

Fax: +44 (0)1335 370 074

Email: [landscaping@aggregate.com](mailto:landscaping@aggregate.com)

[www.aggregate.com](http://www.aggregate.com)

