

TFR1000 / TFR2000 FIRE RATED

Uniclass L3272:P7114	EPIC F642:X725
C/SFB (31.9)	Hn6

APR 2017

Features

- » Rigid PVCu profile
- » Weather Rating
Standard/ Flush = Severe
Check Reveal = Very Severe
- » Reduces risk of condensation, mould and moisture migration across the cavity
- » Complies with Part L Building Regulations when the window is installed with a minimum set back of 30 mm
- » One piece profile closes cavities 50-160 mm
- » Ideal for first or second fix
- » Up to one hour fire integrity

Standards

- » ISO 9001 Yes
- » BBA Certificate Yes
- » Part L Compliance 2010 ... Yes
- » Robust Detail BR262 Yes
- » BS EN 13163 Yes

Sustainability

- » ISO 14001 Yes
- » GWP <5
- » ODP Zero
- » Green Guide B



Product Description

TFR1000 and TFR2000 fully insulated cavity closers are an ideal choice for builders and specifiers for the closing of cavities around window and door openings. They comply with the new Part L Building Regulations and can be used for first or second fix installation of doors and windows and in check reveal situations.

Product Function

TFR1000 and TFR2000 has a rigid PVCu profile enclosing a core of CFC free insulation that forms a continuous insulated cavity closer around door and window openings. This prevents cold bridging, damp penetration, air infiltration and condensation. The TFR range can be used on all reveals or cavities and is suited to all types of windows and door frame materials including timber, PVCu and aluminium. The TFR range is available in sizes to fit cavity widths from 50-160 mm.

Installation/ Application Detail

FIRST FIX

First fix applications may be achieved by fixing the closer to a timber former or window and incorporating into the brickwork as it is constructed forming a template to build consistent cavities. First fix cavity closer application requires DTU fixing ties every 225 mm.

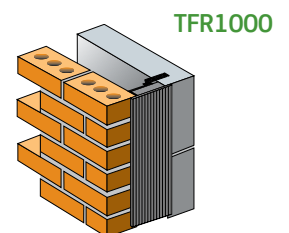

SECOND/ RETRO FIX

Second fix applications are possible by cutting the closer to length, push fitting into the cavity and nailing to the blockwork.

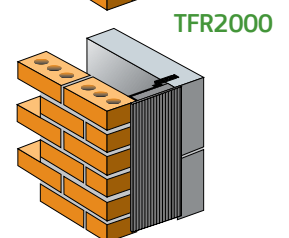

TFR1000 / TFR2000 FIRE RATED CAVITY CLOSERS

Specification

- » Fire Rated.....Yes
- » Check Reveal Available.....Yes
- » 1st Fix.....Yes
- » 2nd Fix.....Yes
- » Min Cavity Width (mm)50
- » Max Cavity Width (mm)160
- » Lengths2.4m
- » Thermal Conductivity (K Value
 λ 90/ 90) = 0.036 w/mk
- » Thermal Resistance (R Value)
= 0.694 m²K/W

Order Codes

STANDARD:

TFR1 + cavity width in mm
(50-100 mm)

TFR2 + cavity width in mm
(110-160 mm)

CHECK REVEAL:

CTFR1 + cavity width in mm
(50-100 mm)

CTFR2 + cavity width in mm
(110-160 mm)

FIXING TIES:

DTU

Technical Data

PROFILE:

Non water absorbing PVCu.

INSULATION:

140 kg/m³ sleeved mineral wool.

FLUSH/STANDARD:

TFR1000

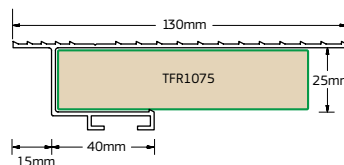

TFR2000

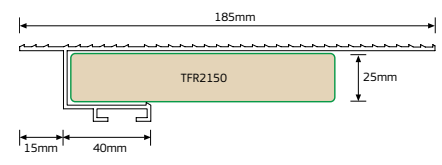

CHECK REVEAL:

TFR1000

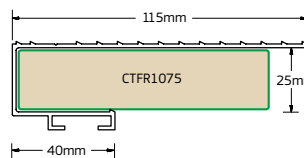

TFR2000

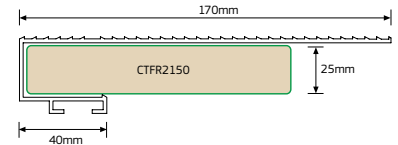

Compliance

TFR Fire Rated profiles were tested at Warrington Fire Research and was found to be in accordance with BS476 Cert 20 1987. TFR1000 provides 60 minutes fire integrity and TFR2000 provides 30 minutes fire integrity.

Recycled Content

All Dacatie Cavity Closers are produced with a recycled content of approximately 50%. The materials used predominately comprise a blend of post-consumer and/ or post-industrial recycled material.

The insulation materials used can typically contain a recycled content of approximately 5%.

Health & Safety

Dacatie has an approved Health and Safety Policy and is committed to working and supplying products safely. A Dacatie COSHH data sheet is available and can be downloaded from the Dacatie website www.dacatie.co.uk.

Environment

Dacatie's closer insulation has no CFC's, HCFC's in the manufacturing process and represents no known threat to the environment. Dacatie's closer insulation has a low impact on the environment and is classified as zero ODP and zero GWP.

Storage & Packaging

Dacatie's closers are supplied in polythene sleeves that are designed for transporting and protecting the products. It is not recommended that the packs are stored in direct sunlight. When storing the Cavity Closers for longer periods of time it is recommended the product should be stored indoors, or under cover.

GWP levels less than 5, ODP Zero and Green Guide A+

Dacatie Insulated Cavity Closers offer different insulation materials with the option of GWP levels of <5, ODP levels of zero and Green Guide ratings of A+

BREEAM (and Code for Sustainable Homes)

BRE has advised that Insulated Cavity Closers as a product do not gain Green Guide credits, since they do not enhance BREEAM scheme categories.

BREEAM®

Building Regulations compliance

Building Regulation (Part L) compliance is important. The path of minimum thermal resistance through the closer must be at least 0.45 m²K/W, which Dacatie closers achieve when the window is installed with a minimum set back of 30 mm.

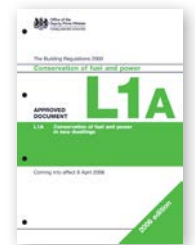

Cold Bridging

The problems of cold bridging are recognised in the Part L Building Regulation 2010 and Scottish Building Regulations 2004. Dacatie Insulated Cavity Closers are used to overcome thermal loss that occurs around unprotected cavities and reveals. Thermal loss can result in problems of condensation, staining and mould growth at the reveals of these openings.

Prolonged exposure to such factors will lead to a deterioration of the internal plaster and paint work. The use of Dacatie Cavity Closers will help to prevent the occurrence of such factors.

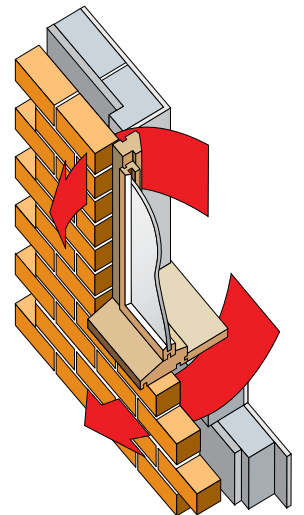

Specification Statement

The insulated cavity closer around window and door openings is to be a Dacatie product, supplied by Quantum Profile Systems Ltd, Salmon Fields, Royton, Oldham, OL2 6JG and installed in accordance with the manufacturer's recommendations.